

April 14, 2021

Subject: Request for Quote #1916-A: Library Repairs due to Auto Accident -Addendum #1

Gentlemen/Ladies:

Below, please find additional information for the above referenced Request for Proposal. You will need to consider this information when preparing your Proposal.

Questions received before the Pre-Quote meeting:

1. What is the estimated construction budget?

The county does not release budget figures. Please price your bid according to the specifications provided.

Questions received during the Pre-Quote Meeting:

2. Are permits needed for the work?

Yes

3. Are any drawings or plans needed to obtain a permit?

Yes, The contractor that is awarded the job should take the drawing provided in this Addendum and markup what they will be doing and submit them with their permit application. See Exhibits A & B attached.

4. What is the process for building inspections and re-inspections?

Contractor will schedule inspection online the day prior by 4pm and the inspection will happen the next day.

5. How much does the re-inspection costs?

The re-inspection fees begin at \$ 50.00 and go up from there. The inspector can impose a \$100 fee first time depending on if the site is ready or not.

6. Will there be any permit fees? Inspection fees?

Work performed for the county requiring building permits by licensed contractors will not have permit fees assessed, although any re-inspection fees for disapproved inspections will be the responsibility of the contractor prior to final inspections and the Certificate of Occupancy or Certificate of Completion being issued.

7. Will we need to replace the column? It does not appear to be damaged, but there was damage around it.

The column is not a part of the scope of work. If it is determined during repairs, that it needs to be replaced, a quote shall be submitted to Fayette County for written approval to repair the column.

8. What are the permissible working hours?

8am-5pm M-Sat, Closed on Sunday
Extended hours must be approved by Fayette County representative.

9. If we cannot match the brick can we spread (pepper) the different bricks?

Consult Fayette County representative prior to process.

10. Will the building inspector come out?

Contractor will schedule inspection online the day prior by 4pm and the inspection will happen the next day

11. The cost of the contingency is high? What will it cover?

The contingency allowance is for any repairs needed outside the scope of work and may only be used with prior written authorization from the county.

12. Are the current plans updated?

Yes, See Exhibits A & B

13. Define the square footage of the area to be repaired?

Exterior wall surface – 12ft H x 20ft W (window to window)

Received by _____ Company _____

Note: Please sign and return this addendum with your submitted quote. Any respondent not returning a signed addendum will still be responsible for compliance with any requirements, specifications, or changes contained in the addendum.

The due date and time remain the same. Quotes will be accepted until 2:00 pm, Wednesday, April 21, 2021. The time allowed for questions has expired.

Thank you for your attention to this matter.

Sincerely,

Natasha Duggan for T. Burgess

Ted L. Burgess
Director of Purchasing

TLB\tc

EXHIBIT A

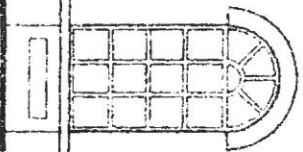
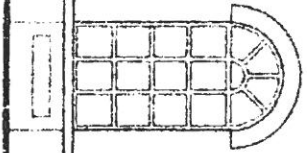
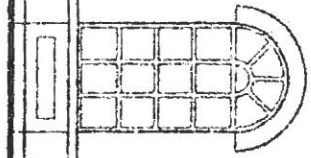
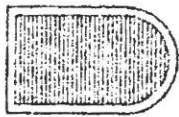

+

EXHIBIT B

