

April 30, 2018

Subject: ITB #1489-B: Antebellum Way Culvert Replacement – Addendum 1

Gentlemen/Ladies:

Below, please find responses to questions, clarification, or additional information for the above referenced Invitation to Bid. You will need to consider this information when preparing your bid.

1. Is the County purchasing the culverts? Or should the Contractor include purchasing culverts in their bid?

The contractor will be required to purchase and install the culverts.

2. Will a split pre-cast culvert be acceptable for the project?

A split pre-cast culvert is acceptable for the project.

3. Is the water main dual feed?

The water main is a single feed.

4. The plan C-103 shows 16” casing the detail on C-504 shows 18” casing what is the correct Dia.?

The casing for the water main shall be 16” in size.

5. Is the city taking care of the gas line relocation and any other utilities with the exception of the water main?

The contractor will coordinate with the other utilities for the relocation, however, the contractor will only be responsible for performing the water main relocation.

6. Do you have a culvert foundation detail?

The culvert foundation shall be in compliance with GDOT detail.

7. Will compactable dirt be acceptable backfill or will stone be required to road sub grade?

Suitable soil is acceptable to use for backfill up to the road sub grade.

8. There is no erosion control plan. Can you provide that or clarify how Erosion control will be done?

Please find the attached sheet C-105 – Erosion Control Plan which is included in this addendum.

9. Is there any foundation backfill material required?

Culvert foundation backfill material shall be in compliance with GDOT detail.

10. The drawings show pouring a concrete apron at the up and down stream side of the culvert this will not be possible with the middle culvert section lower than the outer sections?

The triple box culvert will have a concrete apron for each box on both the upstream and downstream sides. The reinforcement of the apron will be #4 bars, 12” O.C. both ways. Each culvert will have concrete aprons matching the elevation of the invert of the respective box and the concrete turn downs of all of the culverts will terminate at the same subgrade elevation. The outer culverts will have longer turn downs to match the turn down of the center box culvert.

Received by _____ Company _____

Note: If this addendum is not returned to the Fayette County Purchasing Department or if it is returned not signed, all responders shall still be responsible for the requirements of this addendum and the specifications or changes herein.

The opening date for this Invitation to Bid has not changed. **The opening date is: 3:00pm, Thursday, May 3, 2018.** Bids must be received in the Purchasing Department at the address above in Suite 204 on or before the opening date and time.

So that this project can be completed in a timely manner, the time for submitting questions has expired.

If you have already submitted a bid, it will be opened and read on the opening date. If you would not like your bid opened or should you desire to submit a new bid, your original bid must be picked up, or you must notify the Fayette County Purchasing Department **in writing** to, email address: tbarwicks@fayettecountyga.gov or fax to (770) 719-5515 of your desire to not have your bid opened.

Thank you for your attention to this matter.

Sincerely,

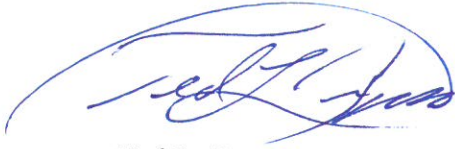
A handwritten signature in blue ink, appearing to read "Ted L. Burgess", enclosed within a large, sweeping blue oval flourish.

Ted L. Burgess
Director of Purchasing

TLB/tcb

Attachment

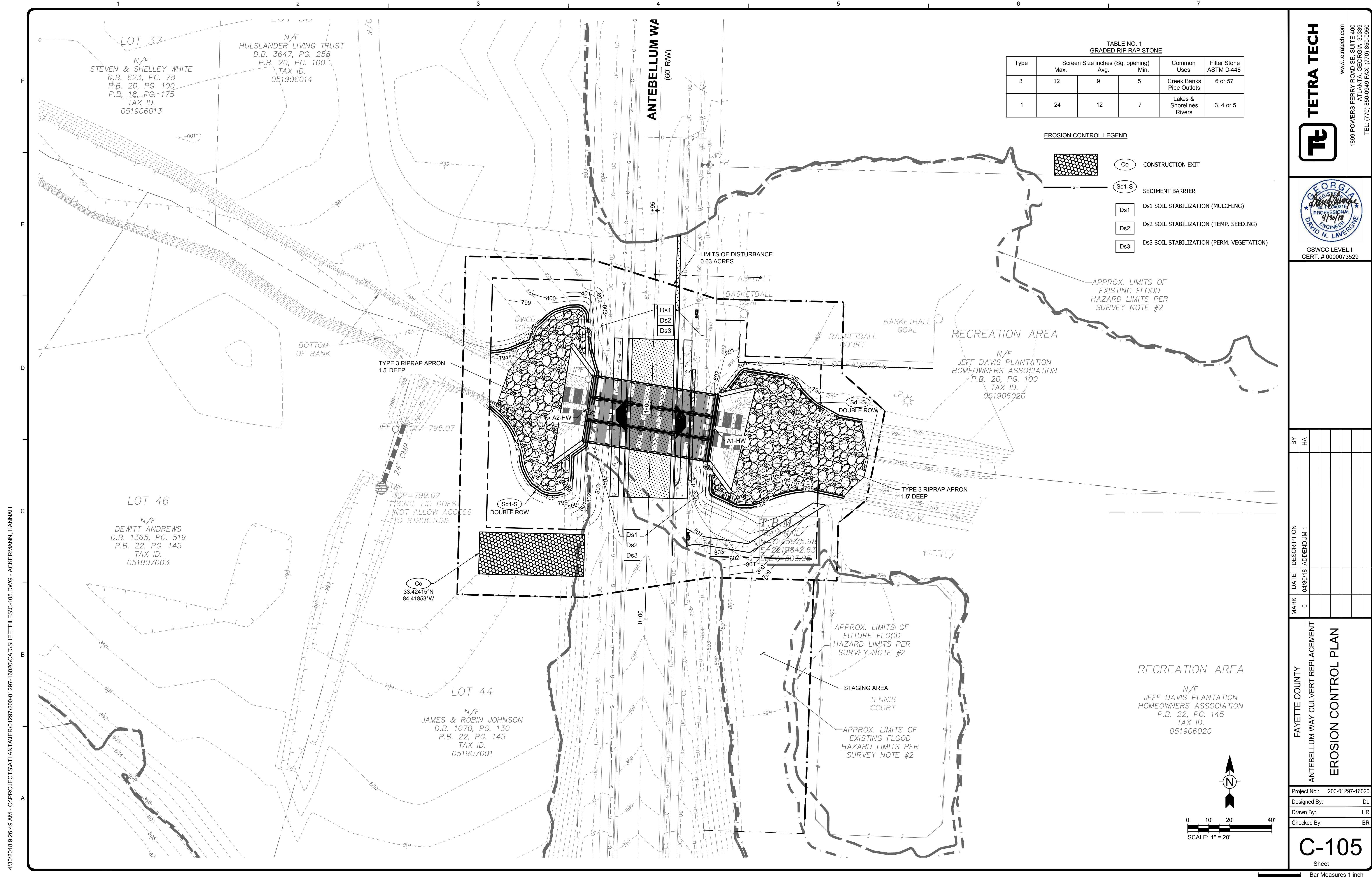

TABLE NO. 1
GRADED RIP RAP STONE

Type	Screen Size inches (Sq. opening)			Common Uses	Filter Stone ASTM D-448
	Max.	Avg.	Min.		
3	12	9	5	Creek Banks Pipe Outlets	6 or 57
1	24	12	7	Lakes & Shorelines, Rivers	3, 4 or 5

EROSION CONTROL LEGEND

- CONSTRUCTION EXIT
- SEDIMENT BARRIER
- Ds1 SOIL STABILIZATION (MULCHING)
- Ds2 SOIL STABILIZATION (TEMP. SEEDING)
- Ds3 SOIL STABILIZATION (PERM. VEGETATION)

TETRA TECH
www.tetrattech.com
1899 POWERS FERRY ROAD SE, SUITE 400
ATLANTA, GEORGIA 30339
TEL: (770) 850-0949 FAX: (770) 850-0950

GEORGIA
PROFESSIONAL ENGINEER
DAVID N. LAVERGNE
GSWCC LEVEL II
CERT. # 0000073529

MARK	DATE	DESCRIPTION	BY
0	04/30/18	ADDENDUM 1	HA

FAYETTE COUNTY
ANTEBELLUM WAY CULVERT REPLACEMENT
EROSION CONTROL PLAN

Project No.: 200-01297-16020
Designed By: DL
Drawn By: HR
Checked By: BR

C-105
Sheet
Bar Measures 1 inch

4/30/2018 9:26:49 AM - O:\PROJECTS\ATLANTA\TAI\ER01297\200-01297-16020\CAD\SHEETFILES\C-105.DWG - ACKERMANN, HANNAH